

B800003



▶ 主要技术特性 (Main Specifications)

- ▶ 适用导线规格 (Applicable wire) : AWG22#~18#
- ▶ 适用基板厚度 (Applicable PC board thickness) : --
- ▶ 温度范围 (Temperature range) : -25°C~+85°C
- ▶ 额定电压 (Voltage rating) : 250V AC, DC
- ▶ 额定电流 (Current rating) : 3A AC, DC
- ▶ 接触电阻 (Contact resistance) : $\leq 0.02\Omega$
- ▶ 绝缘电阻 (Insulation resistance) : $\geq 1000M\Omega$
- ▶ 耐压 (Withstanding voltage) : 1000V AC/minute

材料及电镀规格 Material and Finish

| 型号 Type | 材料 Material | 材料厚度 Material Thickness | 电镀规格 Finish |
|-------------|---------------------|-------------------------|---------------|
| 孔座 HOUSING | PA66 UL94V-0 | — | N/A |
| 端子 TERMINAL | 锡青铜 Phosphor bronze | 0.25mm | 镀锡 Tin-plated |

产品尺寸图 Product size chart

 单位: mm 一般公差: ± 0.20

TERMINAL

B800003-4 YDT236

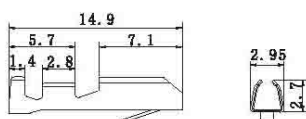

HOUSING

B800003-2-01 YDH236-01E

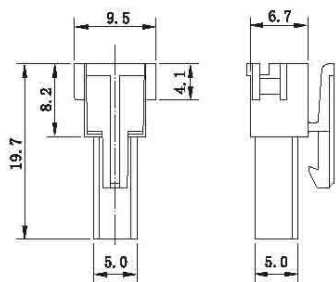

B800003-2-01A YDH236-01P

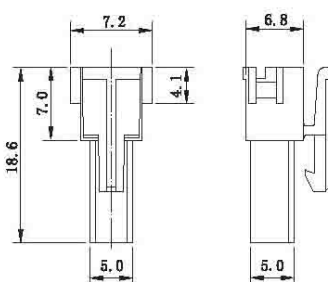

B800003-5-01 YDH236-H01ERT

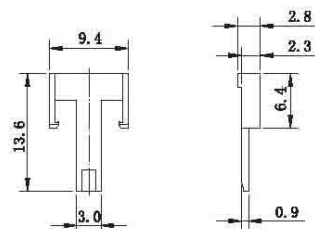

B800003-2-02 YDH236-02E

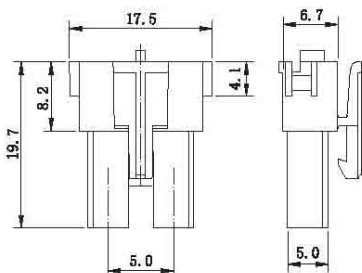

B800003-2-02A YDH236-02P

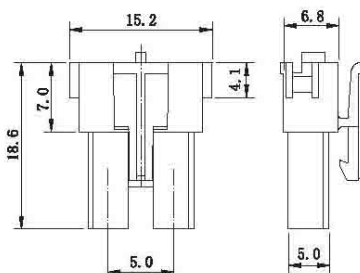

B800003-5-02 YDH236-H02ERT

